



Specification Sheet

Delta Line

(Delta symbolizes change or difference)

Cascade Bookcase

Model #MCS-500

Overview

Transform your classroom entryway into a versatile storage solution with our innovative Classroom Security Cabinet. This multifunctional unit combines premium storage capabilities with enhanced classroom security features, designed specifically for educational environments.

The Classroom Security Cabinet seamlessly rolls into place over existing doorways, maximizing space without disrupting the learning environment. Discover how Morph's locally-crafted solutions meet your storage and security needs, ensuring a safe and organized classroom for teachers and students alike.

Materials

Constructed with durable High Pressure Laminate (HPL) Rubber Edge Protection on the exterior for long-lasting wear resistance, built around a protective UHMWPE Ballistic Panel core for enhanced security. The sturdy metal frame provides structural integrity, while heavy-duty casters enable smooth movement along the integrated overhead track system. Available in various powder coat finish options to seamlessly match existing classroom aesthetics.



Surface Color Options



Frame Color Options

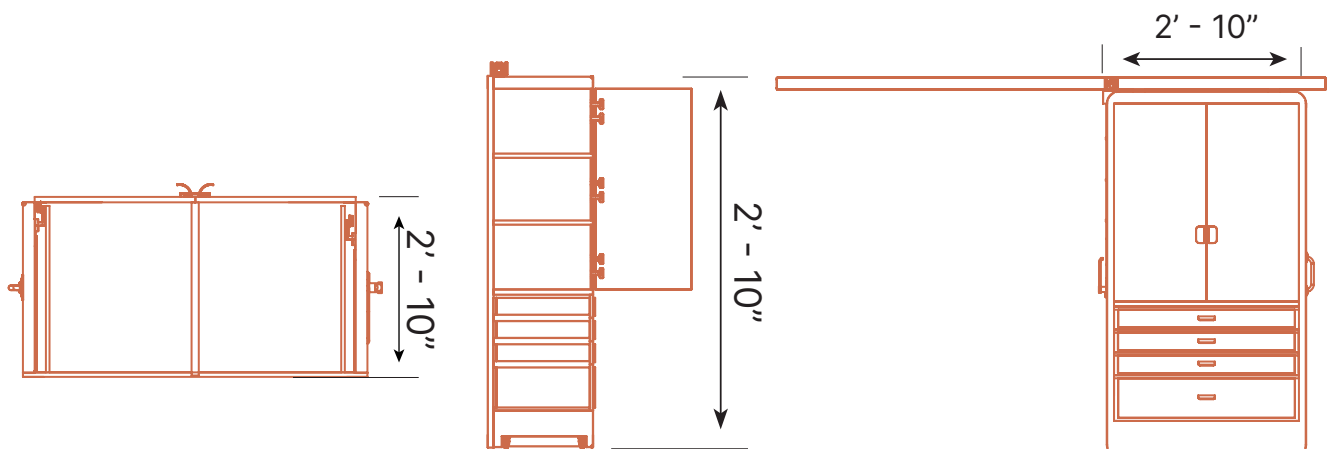
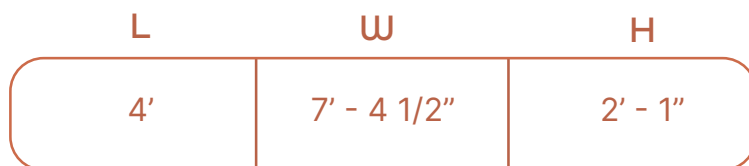

Morph

Specification Sheet

Delta Line

(Delta symbolizes change or difference)

Cascade Bookcase

Model #MCS-500



Cross-Section Of Ballistic Bookcase Backing

High Pressure Laminate 1/32"
Plywood 1/4"
UHMWPE Ballistic Panel 3/8"
High-Density Fiberboard (HDF) 5/16"
High Pressure Laminate 1/32"

- Plywood
- Para-aramid Fabric Layers
- High Pressure Laminate
- High-Density Fiberboard (HDF)

Total: 1"

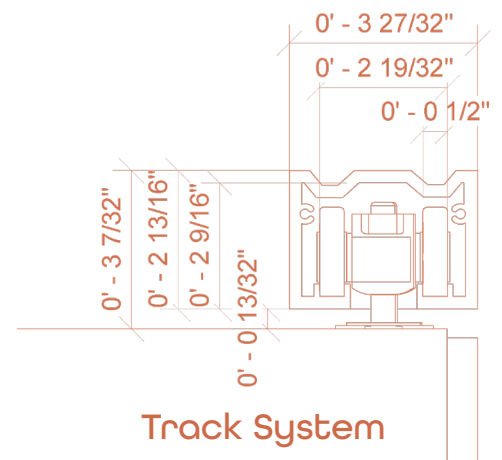

For more information visit website!